

State of Illinois  
 Department of Transportation

Bureau of Local Roads and Streets  
 Plans for Proposed  
 Road District Improvement

Index to Sheets  
 Map Typ. X-Sect. & Quantities  
 Detail Sheet

Sheet 1  
 Sheet 2  
 Sheet 3

County Grundy  
 Road District Saratoga Township  
 Section 16-15000-00-GM, Group IV

ROADS TO BE IMPROVED:  
 MINOOKA ROAD (TR 3C)  
 NELSON ROAD (TR 15)

16-15000-00-GM,  
 GROUP IV

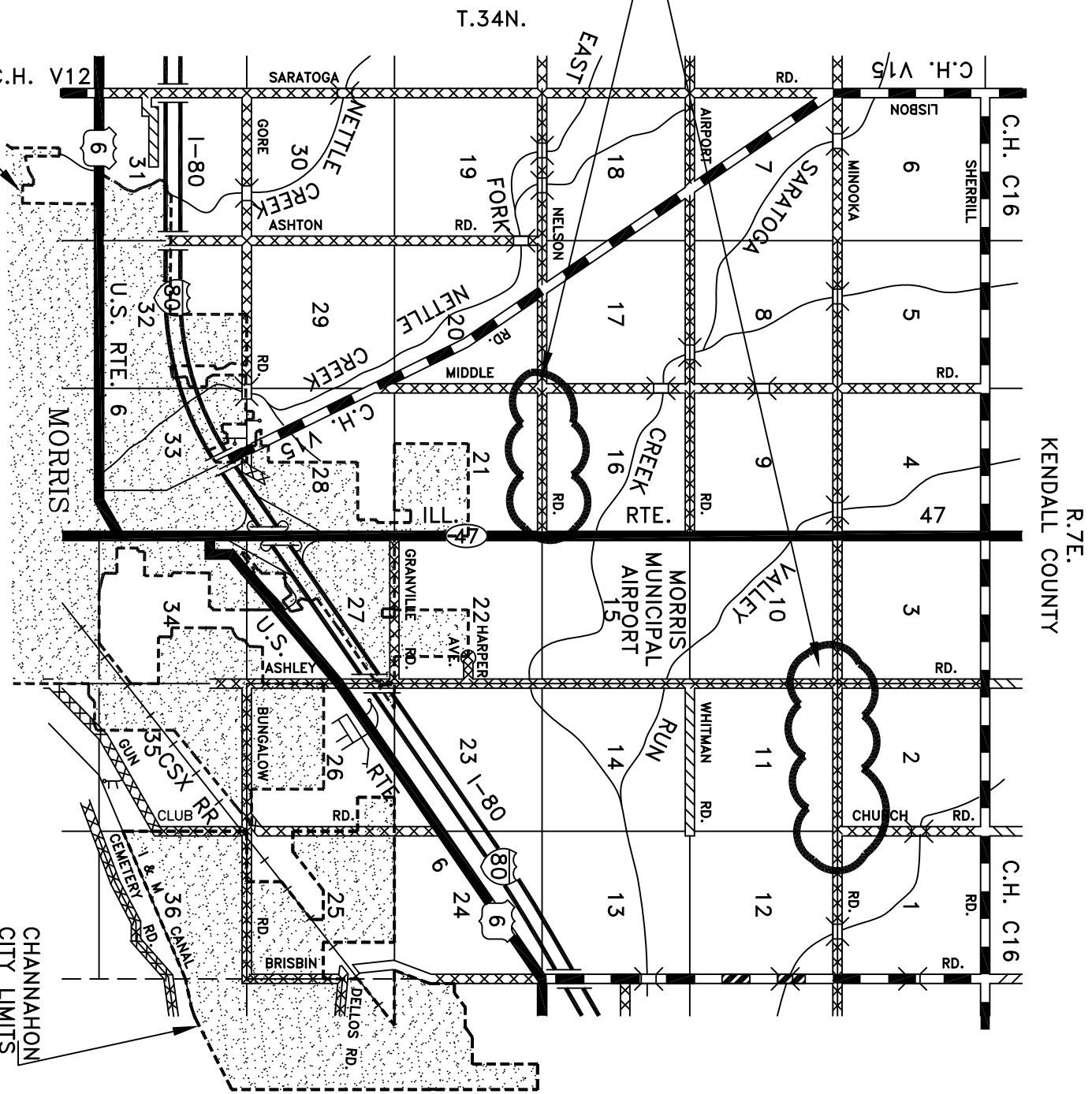

- LEGEND**
- U.S., FEDERAL & STATE PAV'T.
  - C.H. BIT. CONCRETE
  - C.H. OIL & CHIP
  - TWP. BIT. CONCRETE
  - TWP. OIL & CHIP
  - TWP. GR. OR STONE
  - TWP. EARTH
  - PRIVATE
  - TWP. BRIDGE

Approved \_\_\_\_\_ 2016

District/Regional Engineer

Submitted \_\_\_\_\_ 2016

Saratoga Township Highway Commissioner

Grundy County Engineer

Map  
Typ. X-Sect. & Quantities  
Detail Sheet

Sheet 1  
Sheet 2  
Sheet 3

# State of Illinois Department of Transportation

Bureau of Local Roads and Streets  
Plans for Proposed  
Road District Improvement

County Grundy  
Road District Saratoga Township  
Section 16-15000-00-GM, Group IV

Standards

701306-03  
701311-03  
701901-05

Summary of Quantities

HMA Surface Removal - Butt Joints	280	Sq. Yd.
Bituminous Materials (Prime Coat)	5,860	Pound
Aggregate (Prime Coat)	52	Ton
Aggregate Shoulders, Type B	869	Ton
Short-Term Pavement Marking	1,065	Foot
Epoxy Pavement Marking Line 4"	2,664	Foot
Leveling Binder (Maching Method) N30	3,400	Ton
Hot-Mix Asphalt Surface Course "C" N30	1,092	Ton

Typical Cross Section

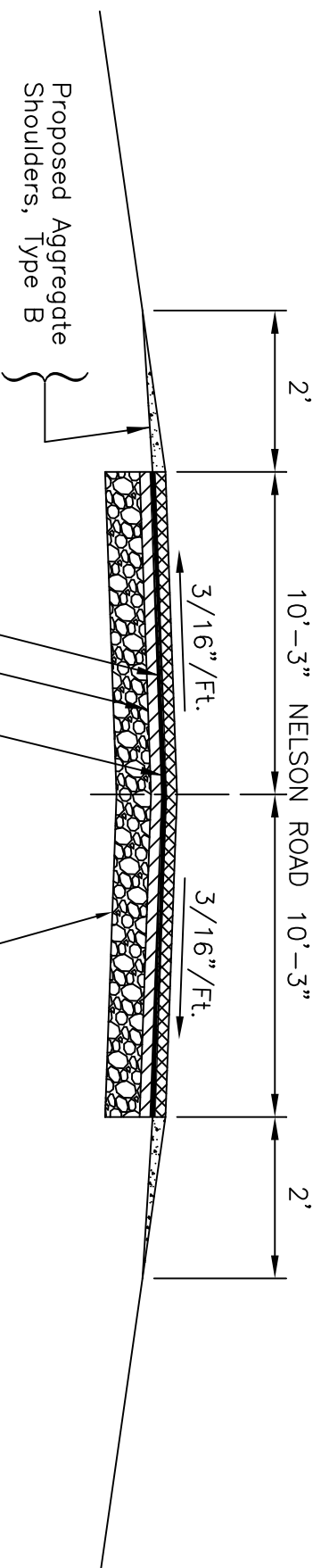

Existing 8' Compacted Aggregate Base, with Hot-Mix Asphalt

**TR15 NELSON ROAD**  
Proposed 1 1/2" Hot-Mix Asphalt Surface Course, Mix "C", N30  
(168 pounds per Sq.Yd.)

Proposed 1 1/2" Leveling Binder (Maching Method) N30 plus 90 lbs. for Crown Correction if needed.  
(258 pounds per Sq.Yd.)

**TR3C MINOOKA ROAD**  
Proposed 2" Leveling Binder (Maching Method) N30 plus 40 lbs. for Crown Correction if needed.  
(264 pounds per Sq.Yd.)

Route	Gross Length Feet	Omission Feet	Net Length Feet	Miles
TR 3C	5,371	0	5,371	1.017
TR 15	5,284	0	5,284	1.001
Totals	10,655	0	10,655	2.018

**PG Grade For Hot-Mix Asphalt**

Mix	PG Grade
Level Binder	58-22
Binder Course	58-22
Surface Course	58-22
Patching	58-22
Base Course and Widening	58-22

\* See Proposal for Specifications

Scales { Plan 1 inch = Ft.  
Profile, Horizontal 1 inch = Ft.  
Profile, Vertical 1 inch = Ft.

### TYPICAL TAPER AT BUTT JOINT

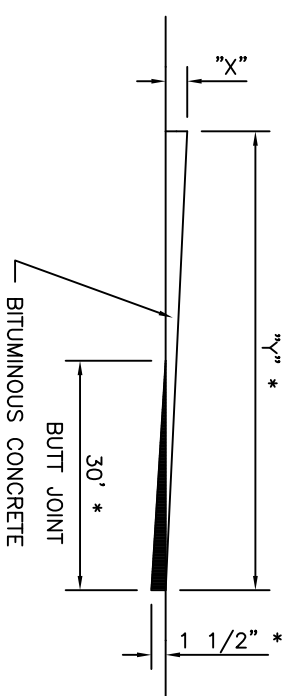

"x" = PROPOSED PAVEMENT THICKNESS

TABLE	
"x"	"x"
1"	20'
1 1/2"	30'
2"	40'
2 1/2"	50'
3"	60'
3 1/2"	70'
4"	80'

\* NOTE: SEE TABLE BELOW FOR DEPTHS. BUTT JOINTS AT PRIVATE ENTRANCES SHALL BE 18" X 1" DEEP.

DEPTH	LOCATION	LENGTH	SIDE	SQ. YD.
TR 3C				
1 1/2"	STA. 0+00	30'	C.L.	70
1 1/2"	STA. 53+71	30'	C.L.	70
1"	2 ENTRANCES @	18"	LT & RT	6
	3 SQ. YD. EACH			
TR 15				
1 1/2"	STA. 0+00	30'	C.L.	68
1 1/2"	STA. 52+84	20'	C.L.	46
1"	7 ENTRANCES @	18"	LT & RT	21
	3 SQ. YD. EACH			
TOTAL				281

### TYPICAL PRIVATE ENTRANCE

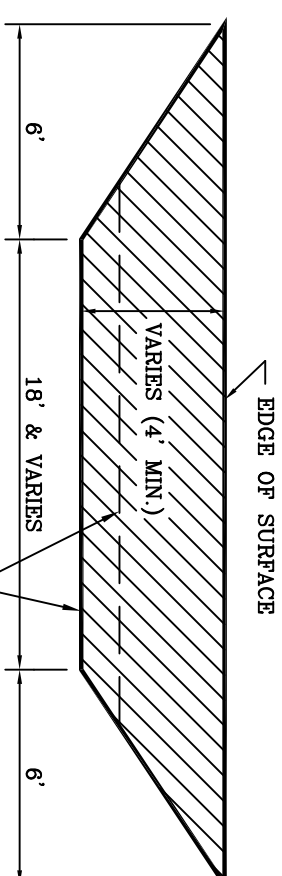

18" X 1" BUTT JOINT  
CONCRETE ENTRANCES WILL HAVE A SAW CUT EDGE

TABLE OF PRIVATE ENTRANCES

LOCATION	STATION	SIDE	SURFACE TYPE	SQ. YD.
TR 3C				
5 LOCATIONS @	VARIABLES	LT & RT	AGGREGATE, HMA OR CONCRETE	50
10 SQ. YD. EACH				
TR 15				
12 LOCATIONS @	VARIABLES	LT & RT	AGGREGATE, HMA OR CONCRETE	120
10 SQ. YD. EACH				
TOTALS				170

### TYPICAL INTERSECTION DETAIL

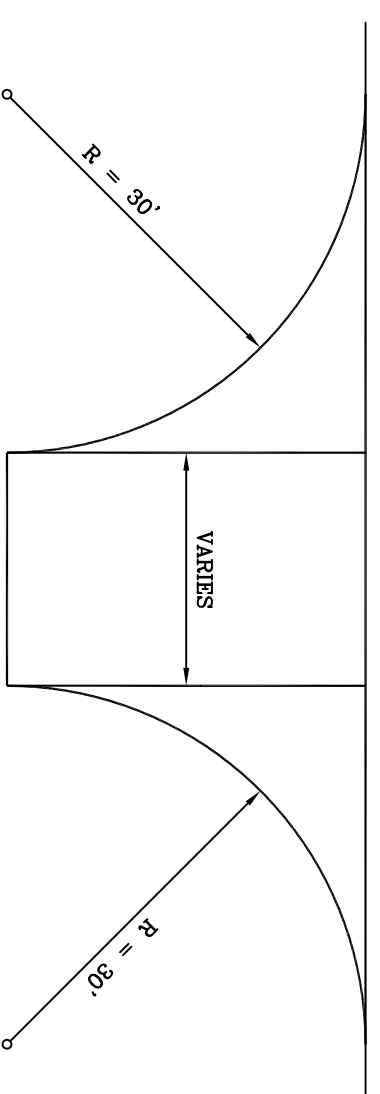

TABLE OF INTERSECTIONS

LOCATION	STATION	SIDE	SQ. YD.
TR 3C			
	0+00	C.L.	110
	53+71	LEFT	110
TR 15			
	0+00	LEFT	110
	0+00	RIGHT	110
TOTAL			440

### TYPICAL MAILBOX TURNOUT

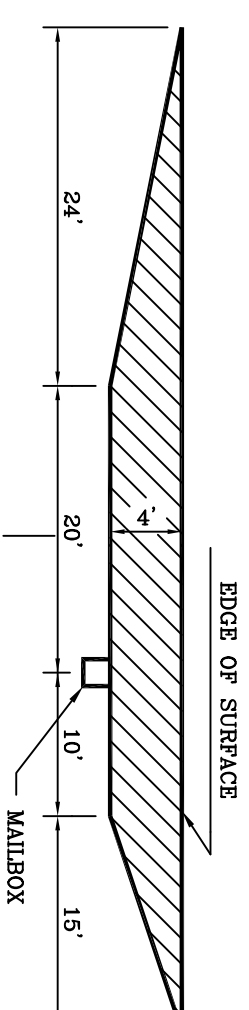

TABLE OF MAILBOX TURNOUTS

LOCATION	STATION	SIDE	SQ. YD.
TR 3C			
2 LOCATIONS @	VARIABLES	LT & RT	54
27 SQ. YD. EACH			
TR 15			
11 LOCATIONS @	VARIABLES	LT & RT	297
27 SQ. YD. EACH			
TOTAL			351